

**PAVED CONDITION**

**UNPAVED CONDITION**

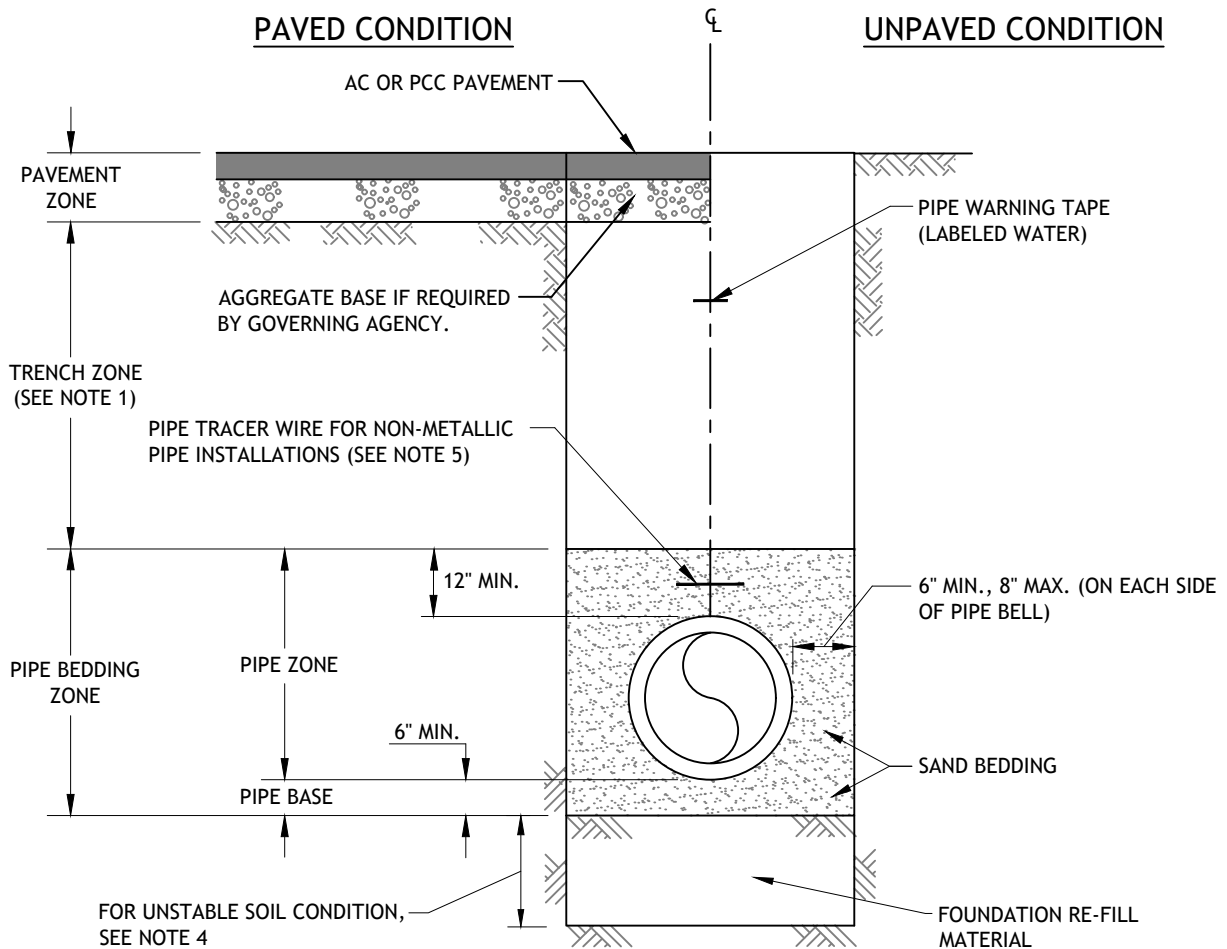

**NOTES:**

1. Compaction for the Trench Zone shall meet the local agency having jurisdiction or whichever compaction requirement is stricter.
2. Pipe base shall be a minimum of 6" in depth. Pipe bedding material shall be per EVWD standard and shall include both pipe base and pipe bedding zone.
3. Contractor shall provide hand excavated "Bell Hole" for each pipe joint so that the weight of the pipe does not bear on the bell. Contractor shall re-fill and hand-tamp each "Bell Hole" prior to completing the placement of pipe bedding.  
  
If unstable soil is encountered, the District Representative shall determine over excavation depth and foundation re-fill material.
4. Where Contractor fails to maintain proper trench width limits, special backfill such as one-sack slurry and bedding shall be used as determined in the field by the District Representative.
5. 14 gauge pipe tracer wire shall be installed and fastened to the pipe and wrapped at 5' intervals around the entire circumference of the pipe.
6. The minimum depth of cover from finish grade to the top of the pipeline shall be as follows, unless otherwise approved by the District Representative:  
 DOMESTIC WATER PIPELINE (1" TO 10" DIA.) = 42"  
 DOMESTIC WATER PIPELINE (> 10" DIA.) = 48"

**WATER TRENCH**

EAST VALLEY WATER DISTRICT, ENGINEERING DEPARTMENT  
 APPROVED BY:

*Jeff Noelte*  
 JEFF NOELTE, P.E. 67924  
 DIRECTOR OF ENGINEERING & OPERATIONS

APRIL 2022  
 REVISION

EVWD  
 STD. DWG.  
**W-121**

SHEET 1 OF 1

REV: 3/30/2022 J.WOLF M:\ENGINEERING - SECURED\STANDARDS\DWG\2022 UPDATE\WATER\W-121 WATER TRENCH 2022.DWG

